

Options and Benefits

TECH INTEGRATION

Integrate public address system, solar power, blue strobe, J-Hook, WiFi, PTZ cameras, and more. Our engineers are ready to incorporate your tech.



BRANDING PROGRAM

Brand your project with school colors, team logos, or a corporate identity that's unique to you. We work with your creative team to provide the exact look and feel you're hoping for.

*Additional cost and lead time may apply.*



FREE CUSTOM CAD

CAD engineers are free to use and on-call to create drawings specific to your project requirements. CAD designs are created within 24 hours.

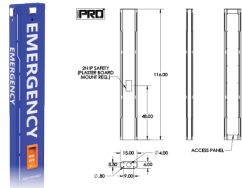

FAST TRACK FABRICATION

12 – 15 days	Standard, no additional charge
10 – 11 days	15% fee
8 – 9 days	25% fee
6 – 7 days	45% fee
4 – 5 days	65% fee
2 – 3 days	100% fee

*Business days exclude weekends and holidays, does not include shipping costs or timelines.*

Product Categories



Why Pedestal PRO

CUSTOMIZATION ■ QUICKEST TURNAROUND ■ HIGHEST QUALITY

With more than 500,000 installations worldwide, including projects for Fortune 100 companies, Pedestal PRO manufactures unique mounting solutions to support consultants, integrators, and installers in the security industry.

Using the most precise device integration methods available, Pedestal PRO custom designs premium pedestals, housings, and mounts to accommodate any physical security device or technology specified by its customers.

Recommended readily-available materials, expedited production timelines, and on-time delivery ensures total satisfaction for every project, every time.



SPEC ANY TECH.  
CONFIGURE YOUR FIT.

PRO Stations™

Revolutionary call stations that integrate any tech into a durable, beautiful, fully-lit architectural design that set them apart from all other solutions. Made from laser-cut aluminum, incorporating any call button of your choice, is fast and simple.

PRODUCT FEATURES

- Specify any intercom of your choice
- Programmable lighting
- Strong aluminum construction
- Variable height 4'–14'
- Easily customizable
- Branding program
- Ready in 12–15 business days or less
- Shippable by UPS, FedEx, or LTL
- Single-person installation process
- FREE custom CAD designs in 24 hours

Areas of Use

- College & Education
- Government & Municipalities
- Corporate Campus
- Transportation
- Healthcare
- Parks & Trails



Key Features

Technical Specs

BASE MODEL

**Removable Top Cap**

Access to mounting plate for additional tech

**LED Strobes**

Blue, programmable with presets, 4 sides

**LED Lighting**

Vertical light strips, programmable with presets (RGBW), 4-sides

**Vinyl Lettering**

"Emergency", reflective, high visibility

**Powder Coating**

Primed and powder coated dynasty blue, UV inhibitor, 10+ year weatherability

**Back Panel**

Removable for easy access

**Octagonal Shape**

Vertical strength and easy to customize for any device (patent pending)

**Power Requirement**

120 VAC for lighting, consult manufacture for device requirements

**Low Profile**

48"-104" H x 15" W x 6" D

**Cost-Effective Shipping**

Individually boxed, ship via UPS, FedEx

**Aluminum Construction**

104" tower weighs 62 lbs

**Internal Mounting Plate**

Welded, no fasteners showing

**Integrate Any Intercom**

Fits Axis/2N, Zenitel, Aiphone, Comelit, Viking, etc.

UPGRADE OPTIONS

**Spec Any Tech**

Easily add tech on top including strobes, surveillance cameras, solar, etc.

**Modular Extensions**

18" extension to add height and integrate additional tech

**Integrated Cameras**

Install cameras of choice into 4 sidewalls

**Custom Lettering**

Choose your text

**Material Choices**

Aluminum, steel, #304 stainless, or #316 stainless

**Powder Coating**

Custom colors based on RAL color system

**Branding Program**

Full color vinyl advertising and graphics

**Foundation Options**

Four simple ways to secure your PRO Stations™ to the ground. When installed correctly, each provide protection from sustained Cat 4 135 mph hurricane force winds.

GROUND TOWER

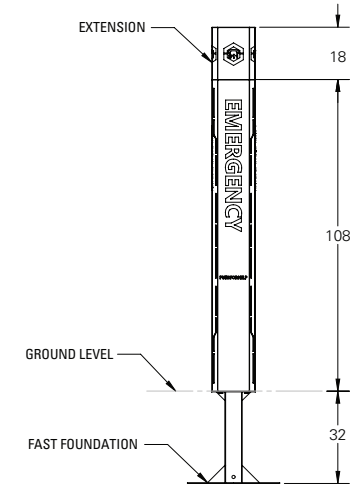
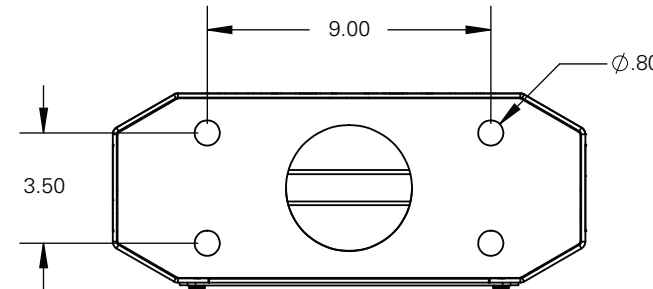

WALL STATION

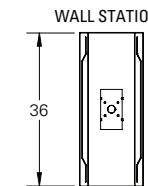
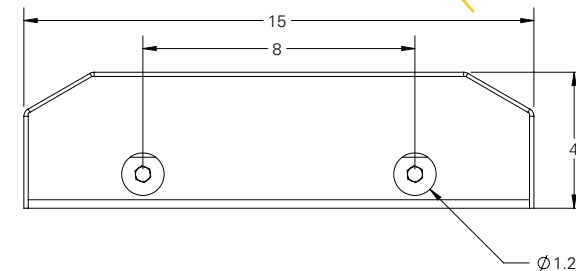

NEED MORE?



Scan the QR code to access downloadable PDF and DWG drawings available to registered architects and engineers at [pedestalpro.com](http://pedestalpro.com).

Part Numbers

These are the ordering SKU numbers for standard aluminum towers/wall mounts. Please speak with our design team to discover custom options including special dimensions, integrated security cameras, steel or stainless steel fabrication, top mounted technologies, colors, branding, and more.

Wall Stations	Hgt	Wdth	Dpth	Wgt	Material	Description	Intercom Cutout Included	Application
156STA-EMER-01-ALU	36"	15"	6"	19 lbs	Alum	Wall Station - Generic	None (cutouts can be added)	Wall mount
156STA-AXIS-01-ALU	36"	15"	6"	19 lbs	Alum	Wall Station - Fits Axis	(1) 2N IP Safety*	Wall mount
156STA-ZENI-01-ALU	36"	15"	6"	19 lbs	Alum	Wall Station - Fits Zenitel	(1) TCIS 2**	Wall mount
156STA-AIPH-01-ALU	36"	15"	6"	19 lbs	Alum	Wall Station - Fits Aiphone	(1) IX-DVF	Wall mount
156STA-COME-01-ALU	36"	15"	6"	19 lbs	Alum	Wall Station - Fits Comelit	(1) 3460EA (Flush)	Wall mount
156STA-VIKI-01-ALU	36"	15"	6"	19 lbs	Alum	Wall Station - Fits Viking	(1) E-1600A-TP-EWP	Wall mount

Ground Towers	Hgt	Wdth	Dpth	Wgt	Material	Description	Intercom Cutout Included	Camera Cutout Included
156TOW-EMER-01-ALU	104"	15"	6"	62 lbs	Alum	Tower - Generic	None (cutouts can be added)	None (cutouts can be added)
156TOW-AXIS-01-ALU	104"	15"	6"	62 lbs	Alum	Tower - Fits Axis	(1) 2N IP Safety*	None (suggested qty 4 Axis F34)
156TOW-ZENI-01-ALU	104"	15"	6"	62 lbs	Alum	Tower - Fits Zenitel	(1) TCIS 2**	None (cutouts can be added)
156TOW-AIPH-01-ALU	104"	15"	6"	62 lbs	Alum	Tower - Fits Aiphone	(1) IX-DVF	None (cutouts can be added)
156TOW-COME-01-ALU	104"	15"	6"	62 lbs	Alum	Tower - Fits Comelit	(1) 3460EA (Flush)	None (cutouts can be added)
156TOW-VIKI-01-ALU	104"	15"	6"	62 lbs	Alum	Tower - Fits Viking	(1) E-1600A-TP-EWP	None (cutouts can be added)

Extensions	Hgt	Wdth	Dpth	Wgt	Material	Description	Intercom Cutout Included	Camera Cutout Included
156TOW-EMER-02-ALU	18"	15"	6"	16 lbs	Alum	Extension	--	None (cutouts can be added)
156TOW-EMER-01-304	27"	15"	12"	12 lbs	304 SS	J-Hook	--	1.5" MNPT

FAST Foundations	Hgt	Wdth	Dpth	Wgt	Material	Description	Conduit Attachments	Pour/Application
66TOW-EMER-01-304	32"	32"	32"	108 lbs	304 SS	Prefabricated anchor	(2) 1/2-13 Tapped Holes	In-ground, gravel/dirt fill
66TOW-EMER-02-304	16"	15"	6"	22 lbs	304 SS	Prefabricated anchor	--	Wet concrete
L-Bolt-625	10"	--	--	12 lbs	Galvanized	L-Bolt Kit (.625" diam)	--	Wet concrete
Stud-Anchor-625	7"	--	--	12 lbs	Galvanized	Stud-Anchor Kit (.625" diam)	--	Existing concrete, retrofit

\*2N IP Safety requires plaster board mount P/N 9151002 \*\*TCIS 2 or equivalent requires flush mount box P/N 107216008140

Axis Communications/2N, Zenitel, Aiphone, Comelit, and Viking are registered trademarks of their respective companies. Pedestal PRO does not represent these brands. Use of them does not imply any affiliation with or endorsement by them. Refer to their websites for more detailed information. Any device shown is not included in a purchase from Pedestal PRO. Product features and dimensions are subject to change at any time. Check [pedestalpro.com](http://pedestalpro.com) for current information.

FAST Foundations™

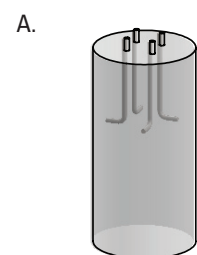

**Poured Concrete**  
L-bolts  
PART: L-Bolt-625

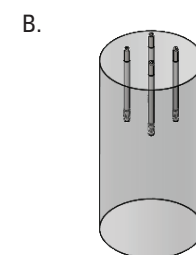

**Existing Concrete**  
Wedge anchors  
PART: Stud-Anchor-625

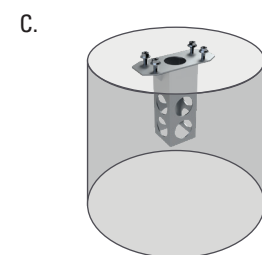

**Poured Concrete**  
Prefabricated anchor  
PART: 66TOW-EMER-02-304

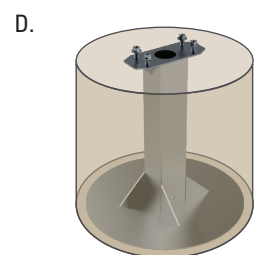

**In-Ground**  
Prefabricated anchor  
PART: 66TOW-EMER-01-304